**TMS**

630 Series* Open

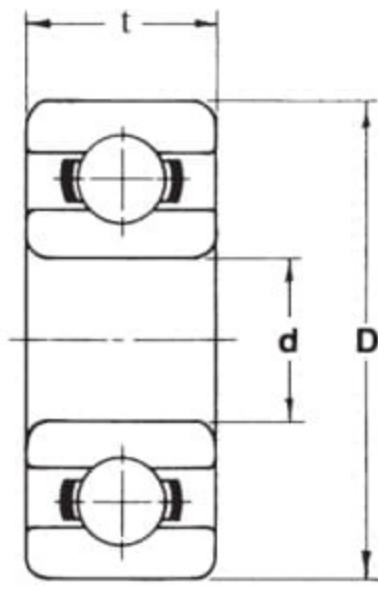

Miniature Ball Bearings

Ball / Roller Bearing

Bearing Number	Equivalent Number	Dimensions (mm)			Basic Load Ratings (N)		Limiting Speeds X 10 ³ (rev/min)		Weight (g)
		Bore d	OD D	Width t	C _r	C _{or}	Grease	Oil	
633	–	3	13	5	1305	490.5	40	48	3.27
634	R-1640	4	16	5	1344	519.9	36	43	5.24
635	–	5	19	6	2335	892.7	32	40	8.50
636	–	6	22	7	3335	1422	30	36	13.90
637	–	7	26	9	4571	1982	28	34	24.20
638	–	8	28	9	4571	1982	28	34	28.10
639	–	9	30	10	4660	2080	24	30	36.20

* All Bearings are available with stainless steel 440C, add prefix "SS"

680 Series* Open

Miniature Ball Bearings

Bearing Number	Equivalent Number	Dimensions (mm)			Basic Load Ratings (N)		Limiting Speeds X 10 ³ (rev/min)		Weight (g)
		Bore d	OD D	Width t	C _r	C _{or}	Grease	Oil	
681	L-310	1.0	3	1.0	74	20	130	150	0.03
681X	L-415	1.5	4	1.2	108	34	100	120	0.10
682	L-520	2.0	5	1.5	167	49	85	100	0.15
682X	L-625	2.5	6	1.8	186	59	71	80	0.20
683	L-730	3.0	7	2.0	314	108	63	75	0.32
684	L-940	4.0	9	2.5	638	226	53	63	0.65
685	L-1150	5.0	11	3.0	716	294	45	53	1.16
686	L-1360	6.0	13	3.5	1079	441	40	50	1.87
687	L-1470	7.0	14	3.5	1177	510	40	50	2.03
688	L-1680	8.0	16	4.0	1256	589	36	43	3.11
689	L-1790	9.0	17	4.0	1324	667	36	43	3.41

* All Bearings are available with stainless steel 440C, add prefix "SS"